

Swivel castor 540 M12 100 PUEL

Furniture Castors Series 540 GW - Wheel PUEL

-20 °C - +60 °C

+++
swivels easily

++
wear resistant

++
shock proof

++
floor protective

++
weather proof

Wheel

coated in polyurethane, 90±3 Shore Aelectrically conductive
<10⁴Ω

High quality nylon wheel centre

Zinc-die-cast housing - chrome plated

Swivel bearing with combined
plain-ball bearing

Wheel brake - glass fibre reinforced

Wheel axle revited

Swivel castor	Wheel-Ø A x width B mm: 100x13+13
---------------	-----------------------------------

Load Capacity kg:	70
-------------------	----

Load capacity tested according to EN 12530 and EN 12527

Overall height H mm:	124
----------------------	-----

Threat mm:	M12x15
------------	--------

Swivel radius SR mm:	93
----------------------	----

Wheel bearing:	Nylon plain bearing
----------------	---------------------

ROLLENBAU

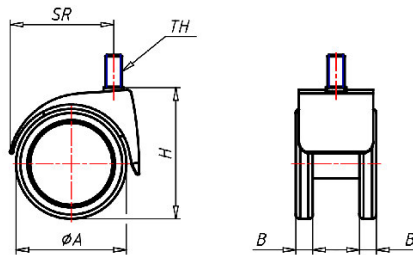

Advantages

- ✓ electrically conductive
- ✓ silent in motion
- ✓ low rolling resistance
- ✓ non-marking
- ✓ high resistance to shocks
- ✓ good chemical resistance

©Copyright 2024 Rollenbau GmbH, www.rollenbau.at 20.05.2024

Applications

- Health-Professionals